

**Your partner
for food safety**

Detectable conveyor belts



Detectable conveyor belts



Chiorino DET™ is a full range of **food grade metal detectable** products.

The exclusive DET™ TPU belt is **recognized** in very **small particles** by the metal detectors used in food processing and packaging.

Chiorino DET™ line guarantees a **safest food production** and **prevents products recalls**.

Key features

EU and FDA food regulations compliant

Excellent resistance to bacteria proliferation and cleaning procedures

Highest detectability

Superior resistance to cut, abrasion and aggressive fats and oils

Benefits

▶ **Guaranteed food safety**

▶ **No food contamination**
▶ **Waste reduction**
▶ **Prevents product recalls**

▶ **Long service life**

DET™ Superior detectability

R&D comparison between Chiorino DET™ line and competitor benchmark shows that the DET™ line is far more detectable: **plus 300%**.

A very small debris of DET™ belt is recognized by the metal detector.

The **prompt identification** and removal of the contaminated product assures a **safest food** processing and packaging.

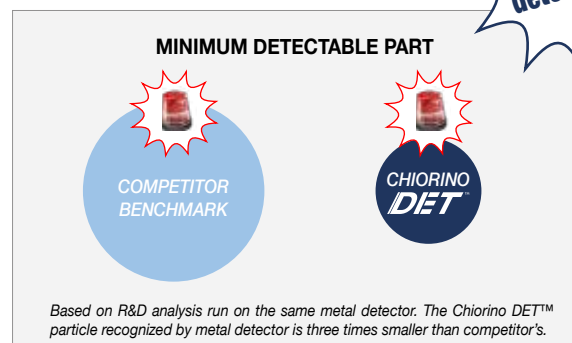

DIET™ Full range

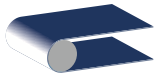

Conveyor belts

Code	Type	Conveying surface coating		Driving surface coating		Perm. antist.	Total thickness	Min. diam. ¹	Pull for 1% elong.	Temperature resistance		Max. prod. width	
		material	colour	material	colour					min. °C	max. °C		
NA-1379	EL4-U20 blue DET	TPU	dark blue	TPU	dark blue	no	2.0	10	4 ²	-30	60	2000	
NA-1323	EL6-U30 blue DET	TPU	dark blue	TPU	dark blue	no	3.0	20	6 ²	-30	60	2000	
NA-1373	2M5 U0-U2 blue DET	TPU	dark blue	-	light blue	yes	1.3	8	5	-30	110	2000	
NA-1374	2T12 U0-U2 blue DET	TPU	dark blue	-	light blue	yes	1.6	25	12	-30	110	2000	

DET™ belts can be supplied with **sealed edges**.

¹ Minimum roller diameter is dependent on the joint recommended by Chiorino.

² EL series belts: pull for 8% elongation

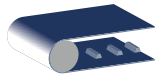

Positive Drive

Code	Type	Total thickness	Material	Colour	Pitch	Tooth section	Tooth length	Pull for 1% elong.	Min. diameter ¹	Temperature resistance		Max. prod. width	
										min. °C	max. °C		
NA-1395F_D6	DRIVE U-U 25/20 blue DET	2.5	TPU	dark blue	20	6 x 3	72	5	60	-20	90	800	

¹ Minimum roller diameter is dependent on the joint recommended by Chiorino.

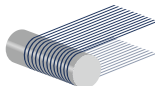

Round belts

Code	Type	Material	Colour	Surface	Diameter	Pull for 8% elongation	Min. diameter ¹	Temperature resistance	
								min. °C	max. °C
ES-790	RU-4 blue DET	TPU	dark blue	smooth	4	30	35	-20	60
ES-791	RU-6 blue DET	TPU	dark blue	smooth	6	70	50	-20	60
ES-792	RU-8 blue DET	TPU	dark blue	smooth	8	130	70	-20	60

¹ Minimum roller diameter is dependent on the joint recommended by Chiorino.



Longitudinal guides and profiles

Code	Type	Dimensions b x h mm	Material	Colour	Hardness	Min. longitudinal pitch mm	Min. longitudinal diameter ¹ mm
ES-751	K6 U blue DET	6 x 3	TPU	dark blue	85 Sh A	40	30
ES-752	K8 U blue DET	8 x 5	TPU	dark blue	85 Sh A	40	40
ES-733	K10 U blue DET	10 x 6	TPU	dark blue	85 Sh A	40	65

¹ Minimum roller diameter is dependent on the joint recommended by Chiorino.

CHIORINO AFFILIATED COMPANIES

Australia

CHIORINO AUSTRALIA PTY. LTD.
Brisbane
Tel. +61-7-3274 1900
sales@chiorino.com.au
www.chiorino.com.au

Benelux

CHIORINO BENELUX B.V. - Utrecht,
The Netherlands
Tel. +31-30-2413060
chiorino@chiorino.nl
www.chiorino.nl

Byelorussia

CHIORINO-K - Minsk
Tel. +375-17-2804578
general@chiorino.ru
www.chiorino.ru

China

CHIORINO ASIA Ltd.
Hong Kong
Tel. +852-397-10818
info@chiorino.asia
www.chiorino.asia

CHIORINO LIAISON OFFICE, Shanghai

Tel. +86-21-37831019
info@chiorino.cn
www.chiorino.cn

France

CHIORINO SAS - Lagny, Paris
Tel. +33-1-64304075
chiorino.paris@chiorino.fr
www.chiorino.fr

Germany

CHIORINO GmbH - Mainz
Tel. +49-(0)6131-55449-0
info@chiorino.de
www.chiorino.de

Hungary

CHIORINO Kft. - Szigetszentmiklós,
Budapest
Tel. +36-24-525930
mail@chiorino.hu
www.chiorino.hu

India

CHIORINO INDIA - Salcete Goa
Tel. +918-322-782454
info@chiorino.in
www.chiorino.in

Italy

CHIORINO PARMA s.r.l. - Parma
Tel. +39-0521-292236
chiorinoparma@chiorino.com

CHIORINO VENETO s.r.l. - Colle Umberto
Tel. +39-0438-430460
chiorinoveneto@chiorino.com

Poland

CHIORINO Sp. z o.o. - Bydgoszcz
Tel. +48-(0)52-3487708
chiorino@chiorino.com.pl
www.chiorino.com.pl

Portugal

CHIORINO PORTUGAL, LDA
Alfena Valongo, Porto
Tel. +35-122-9684442
geral@chiorino.pt
www.chiorino.pt

Romania

CHIORINO srl - Cluj Napoca
Tel. +40-264-432977
chiorino@chiorino.ro
www.chiorino.ro

South Africa

CHIORINO SOUTH AFRICA (PTY) LTD.
Johannesburg
Tel. +27-11-3971268
sales@chiorino.co.za
www.chiorino.com

Spain

CHIORINO IBERICA S.A. - Rubí, Barcelona
Tel. +34-93-5860480
chiorino@chiorino.es
www.chiorino.es

Switzerland

CHIORINO SCHWEIZ GmbH - Wetzikon
Tel. +41-(0)43-3116001
info@chiorino.ch
www.chiorino.ch

United Kingdom

CHIORINO U.K. Ltd. - Featherstone
Tel. +44-1977-691880
sales@chiorino.co.uk
www.chiorino.co.uk

U.S.A.

CHIORINO INC. - Newark, DE
Tel. +1-302-292-1906
info@chiorino.us
www.chiorino.us

CHIORINO DISTRIBUTORS

Albania
Argentina
Armenia
Austria
Azerbaijan
Bangladesh
Belgium
Bolivia
Bosnia-Herzegovina
Botswana
Brazil
Bulgaria
Cambodia
Canada
Chile
Colombia
Costa Rica
Croatia
Cyprus
Czech Republic
Denmark
Egypt
Estonia
Fiji
Finland
Georgia
Greece
Guatemala
Honduras
Iceland
Indonesia
Iran
Ireland
Israel
Ivory Coast
Jordan
Kazakhstan
Kenya
Kirgystan
Laos
Latvia
Lebanon
Lithuania
Macedonia
Malawi
Malaysia
Mexico
Moldova
Morocco
Myanmar
New Caledonia
New Zealand
Nicaragua
Pakistan
Panama
Papua New Guinea
Paraguay
Peru
Russia
Saudi Arabia
Serbia
Slovak Republic
Slovenia
South Korea
Sri Lanka
Sweden
Tadzikistan
Thailand
Turkey
Turkmenistan
Ukraine
United Arabian Emirates
Uzbekistan
Vietnam
Yemen
Zimbabwe

HEADQUARTERS AND PRODUCTION PLANTS

CHIORINO S.p.A.

Via S. Agata, 9
I-13900 Biella, Italy
Tel. +39 015 8489 1
Fax +39 015 849 61 61
chiorino@chiorino.com
www.chiorino.com

UNI EN ISO 9001:2015
UNI EN ISO 14001:2015
OHSAS 18001:2007
EMAS



ENGINEERING ADVICE
ON-SITE INSTALLATION SERVICE
AFTER SALES SUPPORT

